



BAM View is the client magazine of BAM Ireland – Issue 5 – March 2015

## Schools Bundle 4 PPP

### Ministers Announce Construction of Four New Schools by BAM

Building has commenced recently on four new post-primary schools under Schools Bundle 4 of the Government's Public Private Partnership (PPP) Programme. The schools and sports pitches will be built by BAM on greenfield sites. The announcement was made in Dublin on Thursday 8th January by the Minister for Education and Skills, Jan O'Sullivan TD, and Minister for Public Expenditure and Reform, Brendan Howlin, TD at an event to mark the signing of an agreement. The event was also attended by Theo Cullinane, CEO of BAM Ireland, AIB Director of Personal and Business Banking, Bernard Byrne and Garret Tynan from KfW IPEX-Bank.

An estimated 720 jobs will be generated during the construction phase of the schools which will range in size from 6,500 to 10,000 square metres.

The new school buildings are:

1. St Mary's College Dundalk, Co. Louth.
2. St Joseph's Secondary School, Tulla, Co. Clare.
3. Comeragh College, Carrick-on-Suir, Co. Tipperary.
4. Skibbreen School, Co. Cork.

The contract with BAM Ireland for this project entails designing, building, financing, operating and maintaining the educational facilities involved. The cost is spread over a 25 year period through annual inflation-linked payments, the first of which will be made following completion of the first school building in 2016. Annual payments are expected to be approximately €7m.

Minister O'Sullivan said: "I am delighted to see the beginning of construction of almost 3,000 new school places. The students of these four schools will benefit from the opportunity to learn in new and improved teaching spaces and modern educational facilities built to a very high standard. These school places are expected to be available from

the middle of 2016. The timely progression of this project has been made possible by the hard work and dedication of the NDFA and my own Department and the cooperation of all the other stakeholders in the project."

Minister Howlin said: "This project follows the successful financial close of two other PPP projects in 2014. I am especially pleased to see the increased competition to fund our PPPs experienced in this case, and I congratulate AIB and KfW IPEX-Bank on their success in co-funding this education project." BAM Ireland's CEO, Theo Cullinane said: "BAM is pleased to once again invest equity in Ireland's educational infrastructure and to partner with the Department of Education and Skills and the NDFA on this significant project. We successfully delivered eight schools under Schools Bundle 3 and look forward to providing four state-of-the-art, energy efficient schools under this project. The PPP model remains



Picture shows l-r (back row), Garret Tynan from KfW IPEX-Bank; AIB Director of Personal and Business Banking, Bernard Byrne; Minister for Public Expenditure and Reform, Brendan Howlin, TD; Minister for Education and Skills, Jan O'Sullivan TD; Theo Cullinane, CEO of BAM Ireland and Brian Murphy, Chief Executive, National Development Finance Agency. Picture shows l-r (front row), Shane Cheshire (17) and Grace Donnelly (16) from St. Mary's College Dundalk, Co. Louth; Bethan Godber (17) and Shane O'Malley (17) from St. Josephs Secondary School, Tulla, Co. Clare; Aaron Gleeson (14) and Eve Torpey (13) from Comeragh College, Carrick-on-suir, Co. Tipperary.

Mark Maxwell - Maxwell Photography

one of the most effective ways for Government to ensure that our infrastructural development

maintains momentum and that employment within the construction sector receives a much needed stimulus."

were used in the design of the schools, creating Irish jobs for engineers and architects. Three Irish engineering companies and three Irish architectural practices were involved in the project.

The partners also highlighted the fact that Irish professional firms

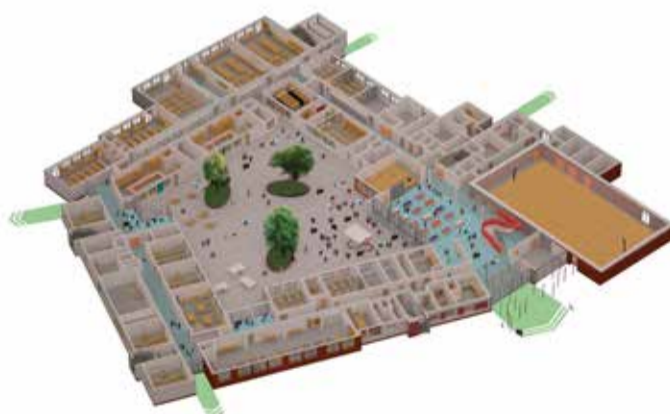

1



2



4



3

# BAM opens Newlands Cross Junction ahead of schedule

'New junction will help traffic flow on important route for business and commuters'



In November 2014, BAM Ireland completed and officially opened the new free-flow junction at Newlands Cross, four months ahead of schedule and within budget. The new flyover, which facilitates nationwide travel from the North to the South of Ireland without any traffic lights, was officially opened today by Minister for Transport, Tourism and Sport, Paschal Donohoe TD.

The project comprised the replacement of the existing signalised junction at Newlands Cross with a grade separated junction carrying the N7 over Belgard Road via a new flyover. The project is a public private partnership (PPP) between BAM Ireland and the National Roads Authority for the design, build, finance, operation and maintenance of the junction. Over 950 construction workers were

involved in the project through its duration.

Speaking at the official opening, Theo Cullinane, BAM Ireland Chief Executive said: "We are proud to open the N7 junction four months ahead of schedule and within budget. The N7 is one of the busiest routes in the country and the new junction will improve traffic flow on this important commuting and commercial gateway. Motorists can now travel the length of the country without traffic lights, a development which is truly remarkable and unique across Europe. I would like to pay tribute to commuters, local residents and business owners for their co-operation and patience while construction was underway, and I can assure them that the new junction will have a positive impact on the area.

"BAM continues to invest in and deliver major social and infrastructural projects that

support the development of the Irish economy. We have completed four major PPP projects in recent years including eight schools under the recently completed Schools Bundle 3 and works have commenced on Schools Bundle 4 PPP. We are honoured to play a key role in transport infrastructural projects which transform Ireland, provide extensive employment and greatly improve road safety."

The N7 / N11 PPP also includes the construction of a 16 km dual carriageway on the N11 between the north end of the Arklow Bypass and the southern end of the Ashford Bypass and the construction of two new grade separated interchanges at the Beehive junction and at Jack White's cross-roads.

This project is expected to conclude in September 2015.



## Minister Lynch turns the sod at Mercer Institute

Minister of State for Disability, Older People, Equality & Mental Health, Kathleen Lynch T.D., turned the sod on the Mercer Institute for Successful Ageing, a €40 million purpose built centre of excellence for the health care of older people which is being delivered by BAM Ireland.



The state of the art facility, located on the existing campus of St James's Hospital in Dublin will provide a centralised facility for the Institute's clinical, education and training, research and creative life work with older people.

BAM Ireland, which has a leading reputation in the delivery of high-tech healthcare and pharmaceutical facilities was awarded the construction contract for the seven storey centre. The build will be completed by late 2015 and will create 300 construction jobs at its peak. The 15,000m<sup>2</sup> facility will include innovative early

diagnostic and rapid access ambulatory care clinics, in-patient acute assessment, rehabilitation and a continuing care unit with 76 ensuite bedrooms and further ward spaces to accommodate a total of 100 beds. The building will also include research facilities, consultation spaces, meeting spaces, catering facilities, day areas, roof terrace spaces, a courtyard and naturally lit foyer and conference rooms.

Speaking at the Sod Turning, Theo Cullinane, Chief Executive, BAM Ireland said: "BAM is delighted to commence construction on the Mercer Institute for Successful

Ageing. We are proud to be involved in another significant project that will benefit Ireland's healthcare system and we have an expert team in place to ensure that we deliver a state-of-the-art facility. Delivering top quality projects safely, on time and within budget is a key priority for our team and we have the specialist skills and expertise to deliver world class healthcare and research facilities."

*Photo: Kathleen Lynch T.D. and Theo Cullinane, CEO BAM Ireland*

## BAM Iridium JV announced preferred bidder for N25 New Ross Bypass

The PPP project, which has a value of approximately €220 million, will involve BAM Ireland, BAM PPP & Iridium, with the consortium referred to as BAM Iridium.

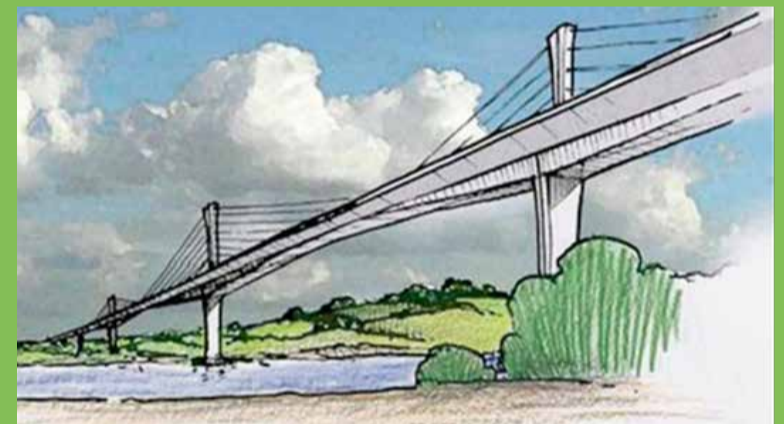

BAM has recently been announced by the National Roads Authority as preferred bidder for the N25 New Ross Bypass. The project includes a major crossing of the River Barrow by way of a 3 tower Extrados bridge, approximately 900m in length with 36m clearance over the river channel, 13.6km of dual carriageway (N25 & N30 routes) and 1.2km of single carriageway (New Ross N30 route). The bridge will extend from Pink Point in Co Kilkenny to Stokestown in Co Wexford. This major investment in Ireland's infrastructure will remove a bottleneck in the South East and improve access from Cork and Waterford to the port of Rosslare.

The project also comprises three roundabout junctions at Glenmore (N25), Ballymacar Bridge (N25), Corcoran's Cross (N30), a compact grade

separated junction on the R733, a railway bridge over the disused New Ross/ Waterford railway line near Glenmore, 11 road bridges and 13 minor structures such as accommodation underpasses.

Theo Cullinane, BAM Ireland Chief Executive, said: "Following the recent opening of the new free-flow junction at Newlands Cross four months ahead of schedule and within budget, BAM is pleased to be named preferred bidder for the N25 New Ross Bypass, which will bring significant transport improvements to the South East region. PPP remains an effective model to continue developing Ireland's infrastructure, which plays a critical role in our economic recovery. We look forward to commencing operations on this important new transport project."

# Albert Quay Development, Cork

In November, An Taoiseach Enda Kenny officiated at the 'Sod Turning' Ceremony at Albert Quay



Theo Cullinane said that they are acutely aware of the urgent need for large floor plate offices in the city centre and said these offices will be built to the highest global standards with full LEED accreditation (the US gold standard for sustainability) and use of the latest efficient and sustainable technology. A new website One Albert Quay has been launched [www.onealbertquay.com](http://www.onealbertquay.com).



Construction of the €45m office development at One Albert Quay, developed by BAM and John Cleary Developments (JCD), has started.

The seven-storey building will accommodate up to 1,800 workers and create 300 jobs during the construction phase. The project will take 15 months to complete.

It will replace the existing warehouses on the site located

opposite the Clarion Hotel. BAM and JCD have already successfully worked together on the largest office development to be built in Ireland during the recession, City Gate Park in Mahon. The complex is now home to companies such as Dell, EMC, RDJ Solicitors, FireEye and VCE.

It is expected that safety company Tyco will be one of the first companies to take up residence at One Albert Quay bringing 500 to 700 employees to the city centre.



# Ambitious development in Abu Dhabi

After completion of the Hazza Bin Zayed Stadium, BAM Contractors along with its sister company BAM International has been awarded the design-and-build contract for phase 2 of this mixed-use development programme.



An artist's impression of Phase 2 of the Al Ain Stadium & mixed-use development.

The vision of the Client AAFAQ Holding, is to have the area surrounding the Stadium to be a fully integrated mixed-use community. This area will be brimming with activity throughout the year and not just on days when the stadium is hosting a football match or cultural event.

This ambitious project will comprise housing (550 apartments in six five-storey buildings), a commercial building, a multi-storey car park, a food and beverage souk and a 172-bed hotel with its own car park (to be managed by the Aloft hotel chain).

The project scope also comprises associated infrastructure such as roads, underground services and the high-quality public area.

ambitious and fast-track project is the logistics of working inside a live existing road network. BAM's Project Manager Quinton Allen said "Traffic is especially busy here on match days or when other events are on. We are countering the day-to-day traffic and the extra pedestrian crowds on match days with designated construction traffic routes and segregated footpaths. This includes designated parking areas, public traffic routes and allocated pedestrian walkways to and from the stadium."

"By the end of 2014, we progressed safely with a significant amount of the superstructure works in all plots and this involved working 24/7 with over 1,500 BAM operatives and a dedicated, motivated site management team."

In total, the phase two works represent approximately 200,000 m<sup>2</sup> of urban area, all of which must achieve an Estidama 2 Pearl rating.

**Challenges in a live environment**  
Among the challenges of this



L-R: Quinton Allen (Project Manager) and Kieran Ladden (Deputy Project Manager).

# Good progress at Aqaba LNG

Work on the LNG terminal in Aqaba, Jordan is progressing nicely.

Most operations on the Aqaba LNG project are running like a well-oiled machine. Bam is working on an EPC contract, which is unlike most of our projects in the region, and have made good progress working on elements of the engineering, procurement and construction simultaneously. The overall efficiency is resulting in a project that is on target. Critical sections of the project are even ahead of schedule, such as the procurement of long-lead items. All of these are due to arrive ahead or on programme, with the exception of some materials and equipment related to instructions that were issued at a later stage.

## Construction ahead of schedule

Swift progress has taken us ahead of schedule on several counts. The piling works and MEP pipework are both a full month ahead. Also, the construction of the approach

trestle is substantially completed. It has been rescheduled to finish some three months ahead of the original schedule, to facilitate acceleration of the MEP 24-inch NG pipeline installation.

On the loading platform, the headstocks have been completed and the installation and in-situ casting of the precast U-beams is 50% complete. At the time of writing, the loading platform was on target for completion by 19 October, which is three and a half weeks ahead of the baseline programme. And, finally, almost two weeks were gained on the original schedule of the terminal building, where we were able to start construction of the roof slab before the end of September.

**Photo:**  
*The approach of trestle, re-scheduled to finish some three months earlier than expected.*



# BAM Ireland to Develop Research Hub at DIT Grangegorman

BAM Ireland has recently been awarded the contract for the design and construction of a new €14.4 million research and incubator facility at Dublin Institute of Technology (D.I.T.), Grangegorman.



The construction project will employ over 140 people and will be completed by September 2015. The 4,414m<sup>2</sup> hub will feature state-of-the-art laboratories, offices and seminar rooms over six storeys with an enclosed plant room at roof level for scientific research.

The facility will be split into two components, with the Environmental Health Sciences Institute (2,400m<sup>2</sup>) featuring laboratories, offices and accommodation for 90 full time research students and 40 research and administration staff working across biological, chemical and physical sciences. This unit will feature dedicated seminar and

meeting rooms, reception and exhibition spaces as well as informal meeting and discussion spaces.

The second unit of the facility is a Hot House Incubator (2,000m<sup>2</sup>) featuring a mix of rentable units of varying sizes for outside companies. A key feature of the design is the flexibility to allow DIT to adapt this space to the evolving needs of its clients. Management office spaces and hot desks are open plan and D.I.T. expects to have 184 business people accommodated in the unit. A mix of meeting spaces will be available ranging from 'phone booth' rooms to a full size boardroom. Discussing the new project, Theo

Cullinane, Chief Executive, BAM Ireland said, "BAM is delighted to be awarded another major project in the science and education space. This facility will be a state-of-the-art working environment to facilitate scientists, students and external industry collaborators, maximising the impact of the research and ultimately driving innovation and job creation."

BAM has a proven track record of delivering cutting-edge science and research facilities and we will bring all of our specialist skills and expertise to this exciting project."

BAM was last year awarded the contract for a €20m Clinical Research Facility and Translational Research Facility (CRF-TRF) at NUI Galway to facilitate cutting-edge medical research side-by-side with patient care in University Hospital Galway.

BAM also recently completed the Centre for Research in Advanced Therapeutic Engineering (CREATE) facility for Cork Institute of Technology, which provides therapeutic solutions in the thematic areas of life sciences, biomedical engineering and photonics.

# BAM recognised as world leader for corporate action on climate change

BAM is now recognised by the Carbon Disclosure Project (CDP) as a Leader in Carbon Performance.

This means that BAM are amongst the best companies in the world when it comes to climate change responsiveness, both in performance as well as in disclosure. It is with help from all employees that BAM, as a Group, managed to report convincingly on how our processes improve and how our projects contribute to less emissions. We have done so one year ahead of our Strategic Agenda target to achieve CPLI in 2015.

BAM is one out of 5 companies in The Netherlands that achieved this special recognition. These are: Heineken, Philips, KPN and ING.

Recognition in the CDLI was achieved by only 9 Construction and Engineering companies globally: Abengoa, Balfour Beatty, Carillion, Doosan Heavy Industries & Construction, Hyundai E&C, Larsen & Toubro, Royal BAM Group nv, Shimizu Corporation, and Taisei Corporation.

The full CSP report is available at [www.cdp.net/CDPResults/CDP-climate-performance-leadership-index-2014.pdf](http://www.cdp.net/CDPResults/CDP-climate-performance-leadership-index-2014.pdf).

**Note on CDP:** The Carbon Disclosure Project (CDP) is an organisation based in the United Kingdom which works with shareholders and corporations to disclose the greenhouse gas emissions of major corporations.

**Benefits to CDP:** Reporting to CDP enables companies to identify emissions sources, which can then reveal carbon reduction opportunities. Reducing emissions through identifying efficiencies and driving innovation, saves money and improves reputation. CDP also helps companies to understand their carbon profile and hence their risk exposure with regard to climate change legislation, such as emissions taxation and/or emissions caps. See [www.cdp.net](http://www.cdp.net) for more information.



## NISO AWARDS 2014

The 23rd Annual National Irish Safety Organisation / Northern Ireland Safety Group (NISO/NISG) Safety Awards took place on 3 October 2014 at a special ceremony in Mullingar.



BAM Civil won the prestigious Civil Engineering Safety Award and BAM Building once again was awarded a Distinction.

BAM has a constant presence at the awards every year through consistently improved health and safety performance. The Awards are highly valued and

regarded among health and safety professionals throughout the island of Ireland and demonstrate the positive and proactive culture of safety management in organisations.

Pauric Corrigan, NISO president, along with Jimmy Fenton, NISG chair, and Mairead McGuinness,

M.E.P., presented awards to over 100 organisations from all around the island of Ireland.

**Photo from L-R** Padraig Walsh, Vera Kilgallon, Brian Abbott, Luke Gibbons, Mairead McGuinness (MEP), Pauric Corrigan (NISO president), Kathy O'Leary, Brian Holmes, Denis McCarthy

### KEY PERSONNEL

Theo Cullinane, CEO  
Brian Fitzpatrick

**BAM Building**  
Ger Harrington  
Perry Haughton  
Denis McCarthy  
Paul Roche

**Regional Directors**  
Michael Gillen  
Ger Moloney

**BAM Civil**  
Brian Cunningham  
Tadhg Lucey  
Paudie Murphy  
John O'Sullivan

**Regional Director**  
Pat Nestor

**BAM Property**  
Ronan Ryan

**BAM FM**  
Michéal Keohane

Business Development Director – Mike Jones  
CSR Director – Tadhg Lucey  
Commercial Director – Jim Martin  
Building Manager, Western Region – Luke Gibbons  
Chief Estimator, Civil – John Murphy  
Chief Estimator, Building – Seamus Brady  
SHE Manager – Kathy O'Leary  
HR Manager – Adrienne Bryan  
ICT Manager – Tim McCarthy  
Plant Manager – Tommy Flaherty  
Procurement Manager – Andrew Kehoe

### OFFICES

**Head Office**  
Kill, Co Kildare  
T: +353 45 886 400  
e: [info@bamcontractors.ie](mailto:info@bamcontractors.ie)  
[www.bamcontractors.ie](http://www.bamcontractors.ie)

**Southern Regional Office**  
Euro Business Park,  
Little Island, Co Cork  
T: +353 21 451 7300  
e: [info@bamcork.ie](mailto:info@bamcork.ie)

**Western Regional Office**  
Unit 5, Liosban Business Park,  
Tuam Road, Galway  
T: +353 91 778 583  
e: [info@bamgalway.ie](mailto:info@bamgalway.ie)